

ADDENDUM #2

FROM : ARCHITECTNICA
555 W. BENJAMIN HOLT DRIVE
SUITE 423
STOCKTON, CA 95207
(209) 952-5850 FAX (209) 952-2442

PROJECT : CODESTACK ACADEMY

LOCATION : 201 North California Street
Stockton CA 95202

REF. # : ARCH PROJ. No. 2023-04

OWNER : San Joaquin County of Education
2707 Transworld Drive
Stockton, CA 95206

DATE : 03 March 2025

NOTICE TO ALL BIDDERS

IT IS THE PURPOSE AND INTENT OF THIS ADDENDUM TO MODIFY AND/OR CLARIFY THE DRAWINGS AND SPECIFICATIONS FOR THIS PROJECT AND THIS ADDENDUM SHALL BECOME A PART OF THE CONTRACT DOCUMENTS. THESE CHANGES AND/OR INTERPRETATIONS SHALL BE INCORPORATED INTO YOUR BID.

REFER TO PROJECT PLANS AND SPECIFICATIONS PREPARED BY ARCHITECTNICA, COVER SHEET DATED 22 January 2025

GENERAL

ITEM 1 PRIME BIDDERS

QUESTION (02.25.25): Please confirm that only prime bidders need to prequalify for this project.

RESPONSE: Only prime bidders need to be pre-qualified for this project.

ITEM 2 JANITORS CLOSETS- WALL BASE

QUESTION (02.26.25) : For Rooms 1-06 (Janitors Closet), 3-09 (Janitors Closet) Plans call for 6" Tile base. Which Tile selection is wanted for these two base areas? Is a Schluter Dilex AHKA base, with a field tile cut down to 6" finished with a Schluter Jolly type trim product wanted? Please advise, and if possible please provide a detail on how this installation is wanted

RESPONSE: Rooms 1-06 & 3-09:

Tile at base of wall to match floor tile TF-1, cut to 6" with schluter cove trim per detail 18/A9.2.10 for tile base.

Detail top of 6" tile as per detail 10/A9.2.10 with 1/8" gap to bottom of FRP with edge trim M370.

See details on attached Sheet RA1.

ADDENDUM #2

ITEM 3 TILE APPLICATION

QUESTION (02.26.25): Spec 09 30 00 Section 2.4B is calling for Epoxy Thinset, this is typically only used in Food Preparation warehouses where the most chemically resistant setting material is necessary. Commercial Restrooms would not fall under this category. Is a Latex Mortar thinset (Mapei Ultraflex LFT, Laticrete 253 or other Mortars of the same ANSI Rating) an appropriate substitution? Please Advise.

RESPONSE: no substitution. please provide specified product.

ITEM 4 BUILDER'S RISK INSURANCE REQUIREMENTS

QUESTION (02.26.25): Per general conditions item 11.3 Builder's Risk. Please confirm whether flood and earthquake insurance coverage is required as this will incur additional costs.

RESPONSE: No change. Please include Flood and Earthquake insurance as required per General Conditions 11.3.

ITEM 5 LANDSCAPE AT PEDESTRIAN ENTRY

QUESTION (02.26.25): Plan sheet CS2

Where the pedestrian concrete walk exits to E Channel Street, the layout of the landscape area is configured differently than the same area as shown on A1.2. Which governs?

RESPONSE: Architectural Sheet A1.2 shall govern for FDC/Landscape area at pedestrian walk on E. Channel Street. (reference image below).

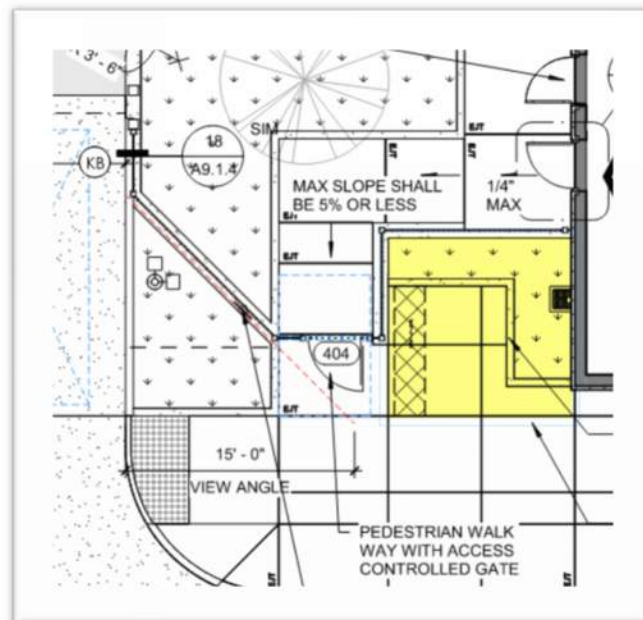

ADDENDUM #2

ITEM 6 RESTROOM ACCESSORIES

QUESTION (02.27.25): The Spec and sheet A7.0.1 are conflicting for the combination Paper Towel (Roll) Dispenser and Waste Receptacle (tag J) and the Hand Dryers (tag K)

Sheet A7.0.1 lists tag J as 046921-6 and the spec lists tag J as Frost Products Ltd. 422-60a

Sheet A7.0.1 lists tag K as XL-SB and the spec lists tag K as XL-GR-H.

please clarify which model is desired for each item

RESPONSE: HAND DRYER: XL-GR-H, as noted in the specifications (Graphite Textured Painted)

PAPER TOWEL/ TRASH : ASI 046921-6 Semi-Recessed as noted on sheet A7.0.1

ITEM 7 DEMO PLANS

QUESTION (02.27.25): Based on new construction provided in structural drawings, please clarify the intent of the dashed lines on demo plans that note stairwell and floor to be removed. It appears that the entire slab area of each level is to be demolished and replaced with new structure.

RESPONSE: Correct. All floor levels are being demolished and replaced. Only the exterior building shell on (3) three sides, will remain. Existing ground level, 2nd and 3rd floors are wood construction. Basement floor is concrete, also to be removed and re-poured 2 feet lower.

ITEM 8 PG&E TRANSFORMER LOCATION

QUESTION (02.27.25): Plan sheet CS2 & A1.4

Area around PGE Transformer on Sheet CS2 shows landscape. Landscape and Site Architectural show pedestrian concrete. Please confirm this is to receive concrete per Architectural . See plan references in email.

RESPONSE: Architectural plans Sheet A1.4 shall govern; concrete surrounding PGE transformer for clear working area.

[illegible]

QUESTION (02.21.25): Request to submit an approved equal/sub request for the hand dryers with our model, the Machflow Plus which comes with a HEPA filter media and ionizer Ion Hygienic

Page 4 of 6 pages

ADDENDUM #2

ITEM 10 FLOOR FINISH – 3RD FLOOR

QUESTION (02.28.25): Please clarify the transition point from TR-4 in Code Space 3-15 to Concrete SC-01 at Elevator Lobby 3 shown on A2.10/2

RESPONSE: Sheet A2.10:

The floor callout tag for Supply room 3-04 and the Elevator lobby 3-01 have been inverted.

Supply room 3-04 should be Floor material SC1.

The Elevator Lobby, and restroom Hall 3-03 floor material continues the TR-4 Floor material as shown in Code Space 3-15

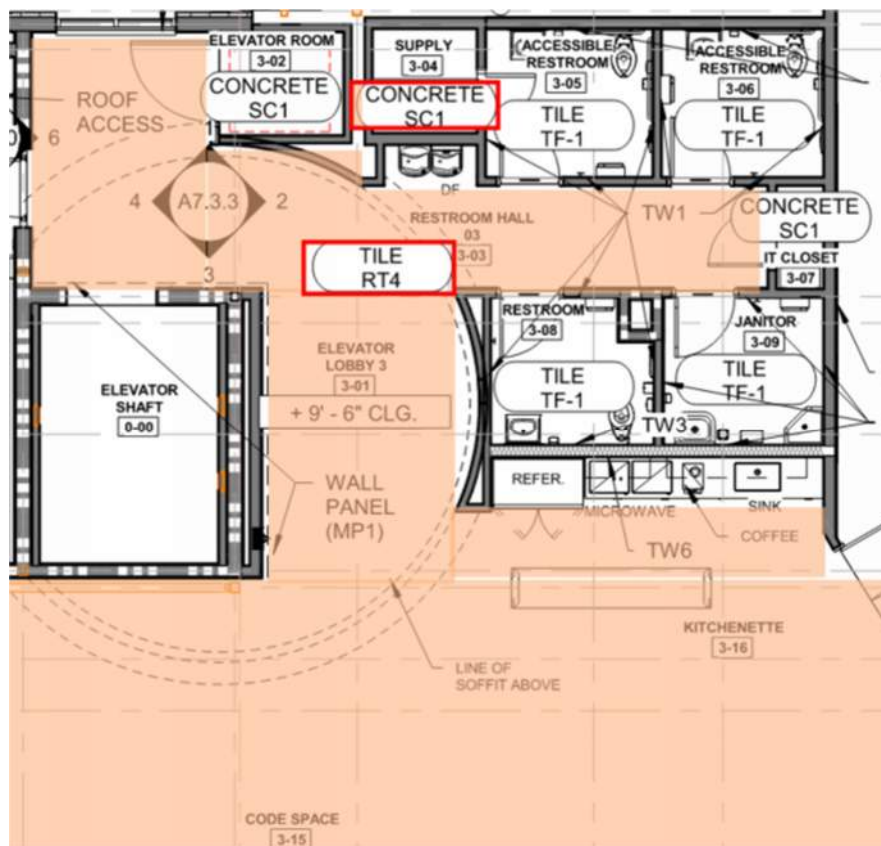

ITEM 11 FLOOR FINISH – 1st FLOOR

QUESTION (02.28.25): Finish schedule A8.5 shows Rubber floor tile at 1-00 Service Lobby 1-00. Floor finish plan A2.9 shows the Service lobby receiving the Tile TF-2. Please clarify

RESPONSE: Sheet A2.9: Please follow floor plan on sheet A2.9, with TF-2 at Service Lobby 1-00.

ADDENDUM #2

ITEM 12 FLOOR FINISH – ELEVATOR

QUESTION (02.28.25): Finish schedule A8.5 shows Elevator shaft 0-00 to receive Resilient Tile. Please clarify which tile.

RESPONSE: The ELEVATOR CAR FLOOR shall receive RT3.

ITEM 13 FLOOR FINISH – 2nd Floor

QUESTION (02.28.25): Please clarify the transition point from RT-1 tile at 2-01 elevator lobby to Exposed concrete at 2-03 restroom hall shown on A2.10/1

RESPONSE: Elevator Lobby 2-01 and Restroom Hall 2-03 both receive RT-1 tile. SC1 is at IT closet 2-19.

ITEM 14 EXTERIOR SIGNAGE BY OTHERS

QUESTION (02.28.25): Please suggest the scope for exterior signage as it mentioned that sign by others

RESPONSE: The exterior signage as shown on sheets 3/ A10.1, 4/ A10.2, & A10.3 have already been fabricated. The Codestack Academy is housing the signs until ready for installation. Both signs have lighting & power that must be installed by project contractor, as well as mounting of the Signs.

Attachments: RA1, Machflow spec

END OF ADDENDUM #2

ARCHITECTURICA

By



Tim Dearborn, AIA
Architect

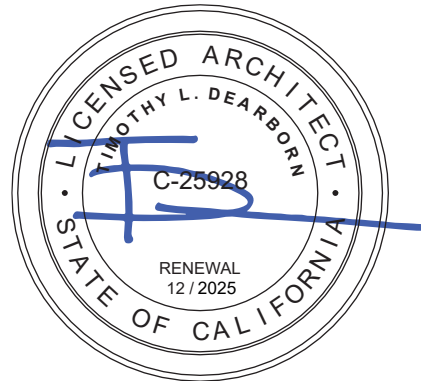

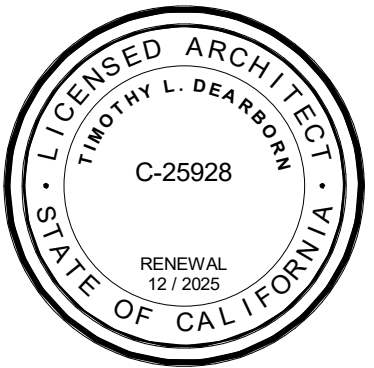
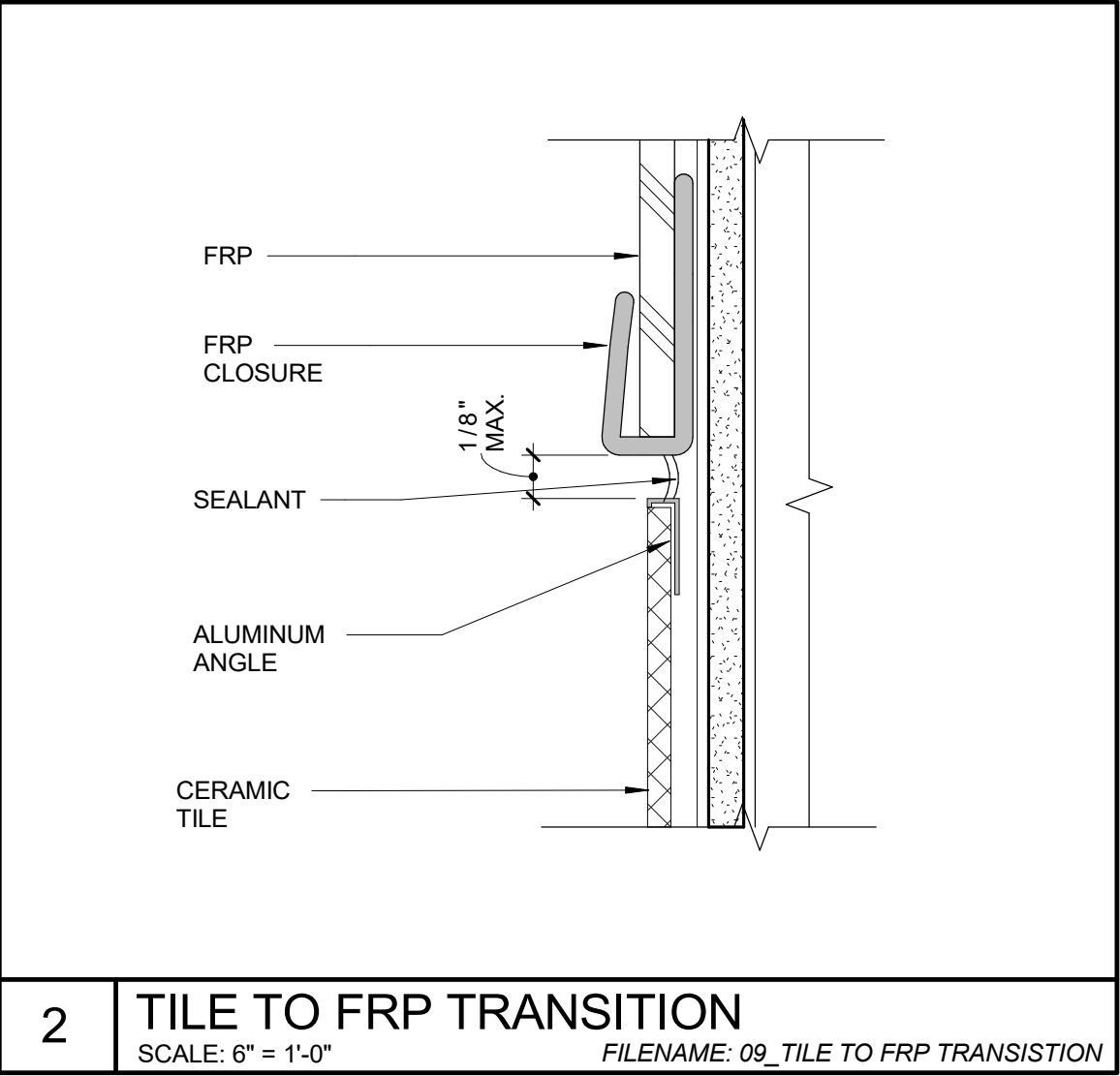
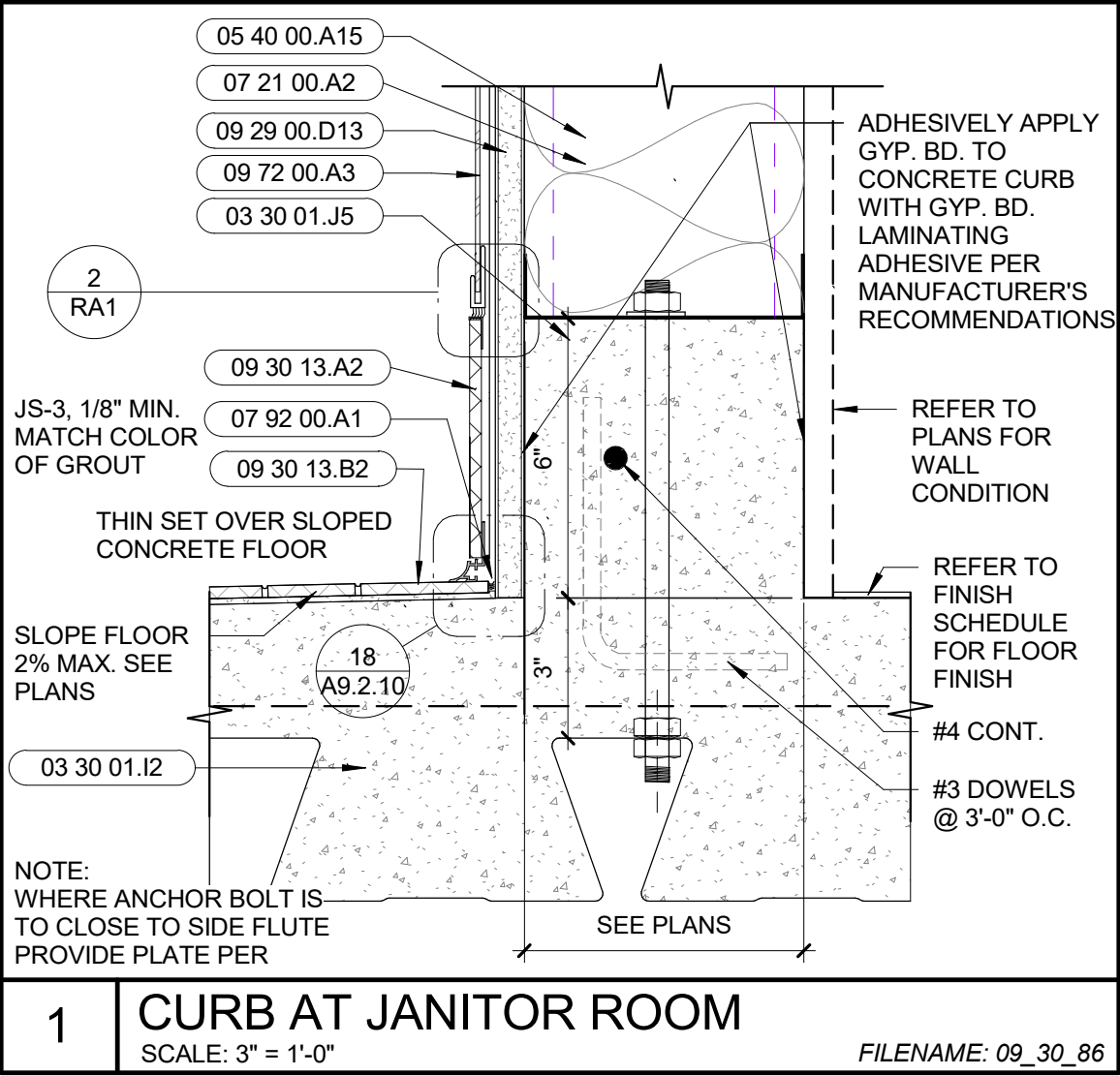

RA1	CODESTACK ACADEMY
	201 N CALIFORNIA ST, STOCKTON, CA 95202
	DET - WALL BASE AT JANITOR

PROJECT NO: 2023-04
ISSUE SET: BID SET
ISSUE DATE: 01.22.25
DRAWN BY: LCG

ARCHITECHNICA



555 West Benjamin Holt Drive
Suite 423
Stockton, CA 95207
P: (209) 952-5850
F: (209) 952-2442
E: info@architechnica.net
www.architechnica.net



SUBSTITUTION REQUEST

(During the Bidding/Negotiating Stage)

Project: SJCOE CodeStack Academy Renovation

Substitution Request Number: _____

201 N California St, Stockton, CA, 95202-2516

From: Saniflow Corp. / Attn: Samantha Layedra

To: ARCHITECTURICA

Date: 2/21/2025

Re: Substitution/ Equal

A/E Project Number: 2023-04

Contract _____

Specification Title : TOILET, BATH, AND LAUNDRY ACCESSORIES

Description: High-Speed Air Dryer

Section: 102800

Page: 5

Article/Paragraph: 2.2K

Proposed Substitution : Machflow

Manufacturer: Saniflow Corp. Address: 3325 NW 70th Ave., Miami FL, 33122

Phone: 305-424-2433

Trade Name: Saniflow, a Mediclinics Company

Model No.: M09AB-UL-ION (Recess kit and
Wall Guard available)

Attached data includes product description, specifications, drawings, photographs, and performance and test data adequate for evaluation of the request; applicable portions of the data are clearly identified.

Attached data also includes a description of changes to the Contract Documents that the proposed substitution will require for its proper installation.

The Undersigned certifies:

- Proposed substitution has been fully investigated and determined to be equal or superior in all respects to specified product.
- Same warranty will be furnished for proposed substitution as for specified product.
- Same maintenance service and source of replacement parts, as applicable, is available.
- Proposed substitution will have no adverse effect on other trades and will not affect or delay progress schedule.
- Proposed substitution does not affect dimensions and functional clearances.
- Payment will be made for changes to building design, including A/E design, detailing, and construction costs caused by the substitution.

Submitted by: Samantha Layedra

Signed by: Samantha Layedra

Firm: Saniflow Corp

Address: 3325 NW 70th Ave, Miami, FL, 33122

Telephone: 305-424-2433 x. 2021

A/E's REVIEW AND ACTION

- ☐ Substitution approved - Make submittal in accordance with Specification Section 01 25 00 Substitution Procedures.
☒ Substitution approved as noted - Make submittal in accordance with Specification Section 01 25 00 Substitution Procedures.
☐ Substitution rejected - Use specified materials.
☐ Substitution Request received too late - Use specified materials.

Signed by: [Signature]

Date: 02/28/2025

Supporting Data Attached: ☐ Drawings ☒ Product Data ☐ Samples ☐ Tests ☒ Reports ☐ _____



<h1>Machflow Plus</h1> <p>(M09A, M09ACS, M09AB) High Speed, Eco-friendly with minimum consumption and ADA Compliant Recessed Kit Available</p>	 	
Comparison	Machflow Plus	XLERATOReco®
Electrical	100V-277V (Universal Voltage)	110-120; 208-277V; 230V
Air Velocity	18,000 LFM (Adjustable)	16,000 - 19,000 LFM
Power	350-1,300 W	425-530 W
Motor type	1/2hp-1 2/5hp 19,000-28,000 rpm (Adjustable)	5/8hp / 20,000 rpm
Heater	250 Watts waved wire Ni-Cr heating self-resettable thermal cut-off at 180°F	No Heat: 4.3 - 4.5 A @ 110-120V
Standby power consumption (W)	2 W	1W
Construction materials	Vandal resistant Epoxy or steel or Stainless Steel	Die-cast Zinc Alloy, (BMC), and Stainless Steel
Air temperature (at 70F ambient)	106°F	No Heat
Color finish	White, Black, S/S Satin	White, Black, Graphite and S/S Satin
Dimensions	13"Hx8-3/8"Wx6-11/16"D	12-11/16"Hx11-3/4"Wx 6-11/16"D
Operation	Touch free infrared sensor. Auto 2 second shutoff after hands are removed	Automatic Sensor Operated
Price Comparison (MAP Price)	\$450	\$585
Weight	11.24 lbs	15-17 lbs
Safety shut off	Shut off after 60 seconds if hands are not removed	Shut off after 35 seconds if hands are not removed
Drying time	Approx. 10-15 seconds	Approx. 12 Seconds
Limited Warranty	5 years	5 years
Noise Level	67-74 dB	65-75 dB
Sensor	infrared (Adjustable 2"-8")	Automatic Sensor
BuildingGreen Approved	Yes	Yes
ADA Compliant Recessed Kit	\$160	\$243

HEPA Filter included

HEPA (Optional Accessory)

Provide ADA Compliant Recessed Kit

M09A-UL-ION / M09AB-UL-ION / M09ACS-UL-ION

General Description

- High-speed hand dryer with HEPA filter media and ionizer Ion Hygienic, recommended for very high traffic areas.
- HEPA filter media filters the solid particles in suspension (pollen, dust mites, tobacco smoke, etc.)
- Ionizer cleans and purifies the air
- California Air Resources Board (CARB) Certified Air Cleaning Device
- Maximum robustness and vandal-proof.
- Air concentrator nozzle which helps to channel better the airflow on the hands
- ADA-Compliant with recessed kit
- Green Spec approved & offering LEED Credits.



Please mark the selected item



code

M09A-UL-ION

material

steel

finish

white epoxy

Components & Materials

- **M09A-UL-ION:** 1/16" (1.5 mm) thick one-piece steel cover; white epoxy finish
- **M09AB-UL-ION:** 1/16" (1.5 mm) thick one-piece steel cover; black epoxy finish
- **M09ACS-UL-ION:** 1/16" (1.5 mm) thick one-piece stainless steel cover; satin finish

Cover fixed to the base with 2 vandal-proof lock screws and lock with special key wrench.

- **BASE PLATE:** Fire retardant UL 94V0 plastic base, with four Ø 7/32" (6 mm) holes for wall mounting. Includes silent-blocks to damp mechanical vibrations.
- **ADJUSTABLE MOTOR:** High pressure universal brush, fully adjustable (19,000-28,000 rpm) potentiometer, Class A.
- **HEATING ELEMENT:** 250 Watts waved wire Ni-Cr heating that incorporates a self-resettable thermal cut-off at 180°F.
- **ADJUSTABLE SENSOR:** Electronic infrared detection sensor with fully adjustable (2"-8") potentiometer. Includes polycarbonate viewing windows.
- Automatic disconnection system after 60 seconds of continuous use.
- **HEPA FILTER MEDIA:** Which filters the solid particles in suspension (pollen, dust mites, tobacco smoke, etc.) significantly improving air quality.
- **IONIZER:** Cleans and purifies the air through negative ions (anions), removing microscopic particles from the air and make it healthier.



code

M09AB-UL-ION

material

steel

finish

black epoxy



code

M09ACS-UL-ION

material

stainless steel

AISI 304

finish

satin

Technical Specifications

Voltage - 100-120V; 208V; 220-240V; 277V	Total power – 350-1,300 W
Frequency - 50/ 60 Hz	Motor Power – 350-1,050 W
Insulation - Grounding required (Class I)	Heating element: 250 W
	Consumption
Dimensions - 13"H x 8 3/8"W x 6 11/16"D	5.6-10 A (120 V) 7.5 - 11A (230 V)
Weight - 11.24 Lbs.	r.p.m. - 19,000-28,000 rpm
Effective airflow - 72.54 CFM	Air temperature – (at 4" distance/ T amb. 70 °F) 106 °F
Max air velocity - 300 mph / 18.000 LFM	Drying time - 10 – 15 sec
Protection level - IP23	Noise level (at 79") - 67 – 74 dBA

Mounting -

Surface-mounted: not ADA compliant

Recessed (with recessed kit): ADA compliant

Operation

Place the hands under the air outflow valve. The dryer will start automatically, and go on with no interruption as long as the hands are kept in the detection range of the sensor. The appliance will stop 2 seconds after the hands are removed from the airflow.



Saniflow Corp reserves the right to make changes and/or modifications to the products and their specifications without warning or notice.

For further info please contact SANIFLOW on: Toll free: 1-877-222-9125 or visit our website at www.saniflowcorp.com

Tel: +1 (305) 424 2433 Fax: +1 (305) 424 2435 · sales@saniflowcorp.com

Installation

Verify all rough-in dimensions prior to installation. Hand dryers require a dedicated circuit and must be properly grounded. a GFCI (Ground fault circuit interrupter) is recommended. One side of dryer show be mounted to a stud.

Certificates & Qualifications

Unit shall be UL and CSA approved, according to UL 499, CSA C22.2 standards, CARB-Certified Air Cleaning Device and GreenSpec approved.

Nº dryers to be fitted

- In toilet areas with a normal frequency of use and only one wash-basin: 1 dryer.
- In toilet areas with a normal frequency of use and more than one wash-basin: 1 dryer for each 2-3 wash-basins.
- In toilet areas with multiple wash basins: 4 wash basins: 2 dryers; 1 row of 6 wah basins: 2-3 dryers; 1 row of 8 wash basins: 3 dryers.

Ideal location

Between the wash-basin and exit. It is not recommended to install dryer between wash-basins, next to urinals, lavatories and showers. If installing automatic dryers over marble surface or ledge, the minimum distance from the dryer to the ledge must be 15-3/4". It is recommended that hand dryers be distributed throughout the washroom area to avoid overcrowding.

Guide specification

Surface-mounted hand dryer shall have a one-piece steel cover with white epoxy finish (M09A-UL-ION), steel cover with black finish (M09AB-UL-ION), or stainless steel cover with satin finish (M09ACS-UL-ION). Hand dryer shall include a fire resistant UL V0 plastic base, fully adjustable (2" to 8") infrared sensor potentiometer and fully adjustable (19,000 - 28,000 RPM) universal brush motor. Dryer shall operate at 67-74 dBA while delivering 68-108 CFM of air at 106 °F and 203 mph as maximum air velocity (Max - 18,000 LFM) during user controlled drying cycle. Dryer shall have a total power of 350-1,300 W with a consumption of 6.4 to 10 A. Hand dryer shall assembly an HEPA filter media which filters the solid particles in suspension (pollen, dust mites, tobacco smoke, etc.) significantly improving air quality and an ionizer (Ion Hygienic Technology) which cleans and purifies the air through negative ions (anions) removing microscopic particles from the air and make it healthier

Unit shall be UL and CSA approved, according to UL 499, 13th Edition, CSA C22.2 standards, CARB-Certified Air Cleaning Device and Green Spec approved

Overall dimensions:

13"H x 8 3/8"W x 6 11/16"D (330 mm x 213 mm x 170 mm)

Weight: 11.24 Lbs. (5.1 Kg)

Recommended heights from floor

	Male	Female	Child	Disabled
x To top of machine	59" / 150 cm	57-1/8" / 145 cm	49-1/4" / 125 cm	51-1/8" / 130 cm
y To mounting brackets	57-1/2" / 146 cm	55-1/2" / 141 cm	47-5/8" / 121 cm	49-5/8" / 126 cm
z To sensor top	46-1/8" / 117 cm	44-1/8" / 112 cm	36-1/4" / 92 cm	38-1/4" / 97 cm

Job:

Model number:

Variations:

Architect / Engineer:

Contractor:

Customer / Wholesaler:

City / State / Country:

Date:

Quantity:

MOUNTING

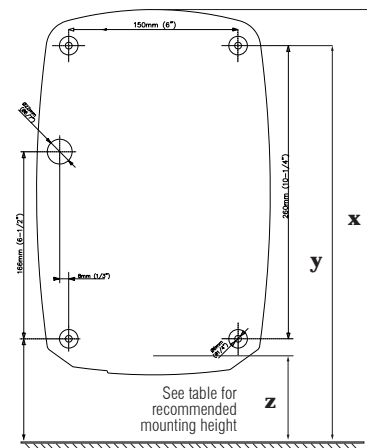

M09A-UL-ION/ M09AB-UL-ION / M09ACS-UL-ION

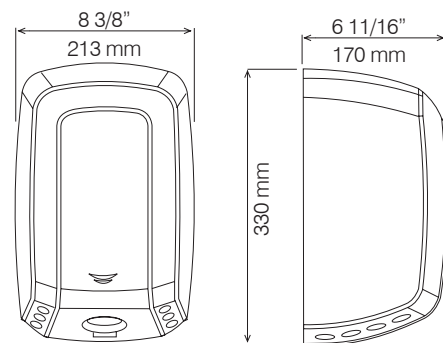

Serial mounting

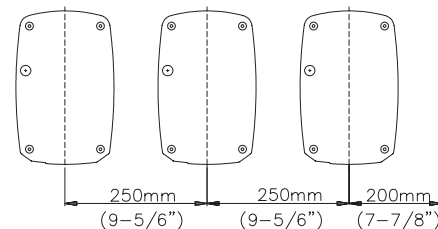

Saniflow Corp reserves the right to make changes and/or modifications to the products and their specifications without warning or notice.

For further info please contact SANIFLOW on: Toll free: 1-877-222-9125 or visit our website at www.saniflowcorp.com

Tel: +1 (305) 424 2433 Fax: +1 (305) 424 2435 · sales@saniflowcorp.com

machflow[®]



- Ultra-fast drying time
- Minimum energy consumption
- Minimum CO₂ emissions
- Minimum noise pollution
- Universal Voltage Out of the box: from 110 to 240 V
- Adjustable High Speed motor: turn up for fast drying; turn down for quiet operation
- Rock solid & Compact Design
- ADA recessed kit available
- GreenSpec listed

To download technical data sheets, 3 CSI Specs, CADs, BIM and Green Info, please go to www.saniflowcorp.com or visit your preferred specification website:

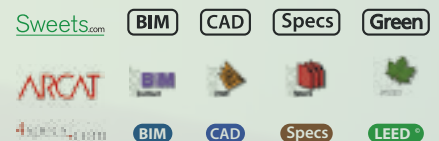



HIGH SPEED



A ROCK SOLID & COMPACT DESIGN

Our most powerful & energy efficient high speed hand dryer incorporates a low energy, high pressure, adjustable motor that allows you to choose noise levels between 67 to 74 dBA. Reduces drying times to 10-15 seconds and utilizes an incredibly energy efficient 6.4 Amps per drying cycle.

HAND DRYERS

machflow®

Who is using MACHFLOW M09A Hand dryers:

- Northwestern University, Kellogs Dorms, Chicago, IL
- Citrus College Football Stadium, Glendora, CA
- Downing University Center, Western Kentucky University, Bowling Green, KY
- Pennsylvania State University, Residential Housing, PA
- Glendale Community College, Glendale, CA
- North Myrtle Beach Park & Sport Complex, SC
- Old Pueblo Gymnastic Academy, Tucson, AZ
- Tegeler High School, Pasadena, TX
- City of SouthPort Public Works, SouthPort, NC
- City of Gridley, KS
- Main Lodge Custodial, Mammoth Lakes, CA
- Vittoria Caffè, Boston, MA

